

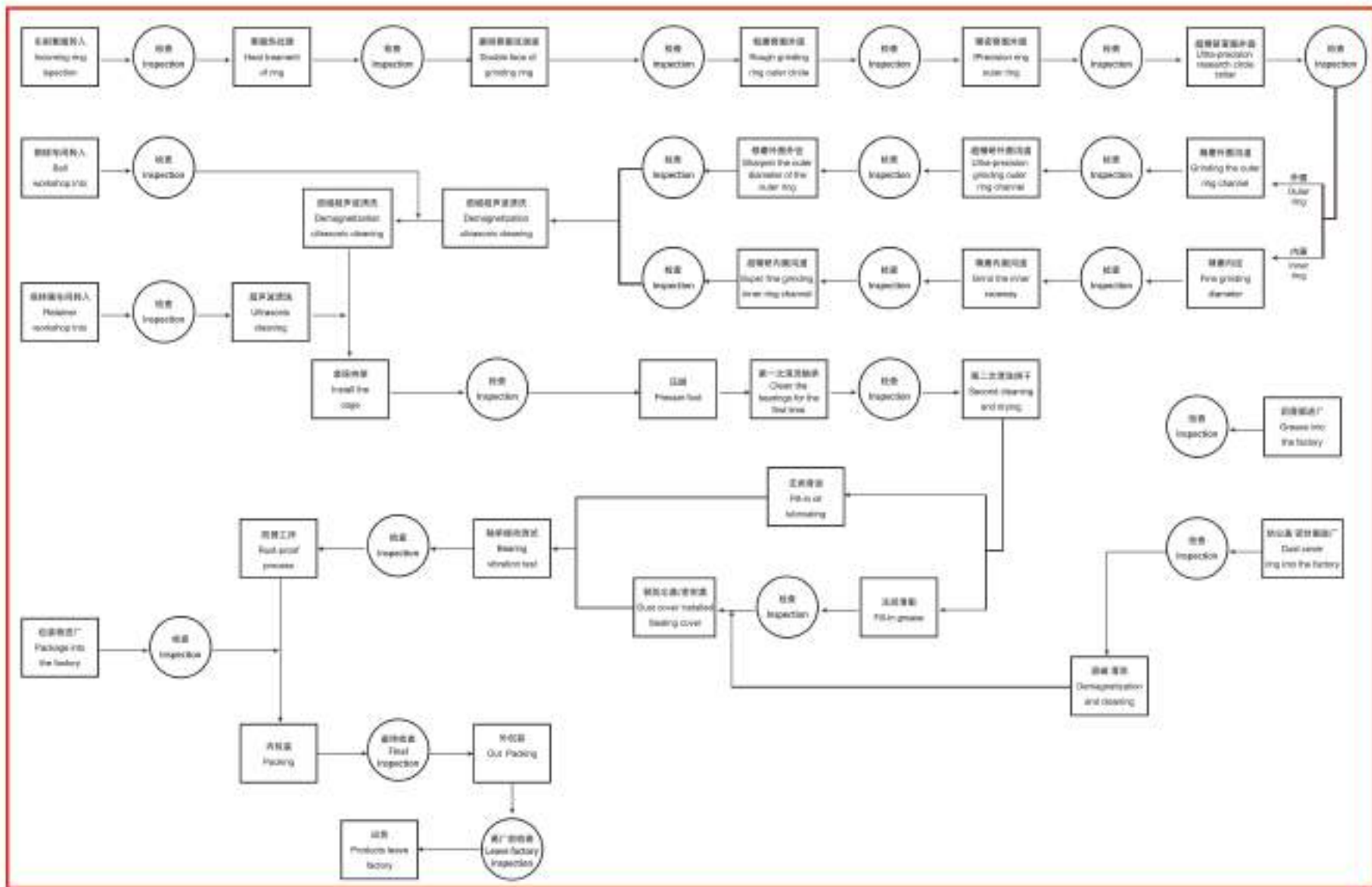

申锡轴承生产工艺流程见图【中文】
PROCESS FLOW OF BEARING PRODUCTION



严谨的生产细节
成就了申锡轴承的大承载力!



原材料

◆ 千挑万选的
优质钢材

大厂钢材
内部杂质少
组织排列有序
轴承承载力更大

◆ High-quality steel

Dachang steel
Internal impurities less
Organized and organized
Bearing capacity greater



热处理

◆ 全球最先进的
淬火技术

贝氏体淬火
内部金相组织良好
硬度从内到外都是国标
均匀的承载力比普通淬火更好

◆ Advanced quenching
technology

Bainite quenching
Internal metallographic
well-organized
Hardness from the inside
out are GB



车/磨加工

◆ 先进的车磨床技术

精密的车磨工序
套圈的精度接近零
套圈的圆度接近零
更均匀的承受大承载力

◆ Advanced car
grinding technology

Precise car grinding process
Femule accuracy / ovality is
near zero
Bearing capacity greater



滚子

◆ 严格把控的滚子

无锡原厂滚子精度高
轴承滚子承载力更均匀到力
普通滚子精度不高, 受力不均匀

◆ High quality raw
material suppliers

Wuxi original high precision
roller
Bearing roller bearing capacity
more evenly to force

产品应用

Product Applications

- ◆ 流体设备
- ◆ 冶金设备
- ◆ 矿山设备
- ◆ 工程机械
- ◆ 纺织机械
- ◆ 通用机械
- ◆ 农业机械
- ◆ 粮食机械
- ◆ 能源机械

- ◆ Fluid equipment
- ◆ Metallurgical equipment
- ◆ Mining machinery
- ◆ Engineering machinery
- ◆ Textile machinery
- ◆ General Machinery
- ◆ Agricultural machinery
- ◆ Cereal and grain processing machinery
- ◆ Energy machinery

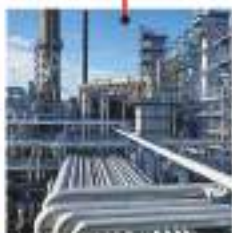

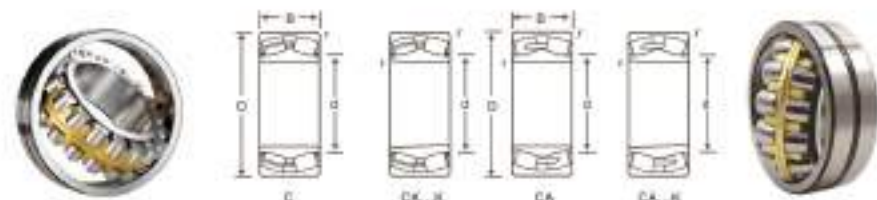

主要尺寸		额定负荷		轴承代号		极限转速		安装尺寸			质量		
Boundary dimensions		Load ratings		Bearing No.		Limiting speeds		Mounting dimensions(mm)			Mass		
(mm)		(kN)		Cylindrical hole		Spherical hole		min	max	max	(kg)		
d	D	B	rsmin	Cr	Cor	圆柱孔	圆锥孔	脂润滑	油润滑				
20	52	15	1.1	33.7	32.1	21304CA	21304CAK	9000	11000	27	45	1.0	0.175
	52	15	1.1	35.8	35.2	21304TN1	21304KTN1	9000	11000	27	45	1.0	0.181
25	52	18	1.0	40.0	42.0	22205CC	22205CCK	8000	10000	30	46	1.0	0.177
	52	18	1.0	40.0	42.0	22205CA	22205CAK	8000	10000	30	46	1.0	0.177
	52	18	1.0	42.2	45.0	22205TN1	22205KTN1	8000	10000	30	46	1.0	0.178
	62	17	1.1	42.7	45.5	21305CA	21305CAK	7000	8000	32	55	1.0	0.277
	62	17	1.1	45.5	45.8	21305TN1	21305KTN1	7000	8000	32	55	1.0	0.258
30	62	20	1.0	34.0	39.3	22206MB	22206MBK	5300	8000	36	56	1.0	0.29
	62	20	1.0	56.0	61.0	22206CA	22206CAK	6300	8000	36	56	1.0	0.3
	62	20	1.0	56.0	61.0	22206CC	22206CCK	6700	8500	36	56	1.0	0.283
	62	20	1.0	58.5	61.3	22206TN1	22206KTN1	6700	8500	36	56	1.0	0.271
	72	19	1.1	67.5	63.9	21306CA	21306CAK	5500	7000	37	65	1.0	0.412
	72	19	1.1	63.8	65.4	21306TN1	21306KTN1	5500	7000	37	65	1.0	0.391
35	72	23	1.1	57.0	71.3	22207MB	22207MBK	5800	7000	42	85	1.0	0.43
	72	23	1.1	75.0	82.0	22207CA	22207CAK	6300	7700	42	85	1.0	0.45
	72	23	1.1	75.0	82.0	22207CC	22207CCK	6600	8000	42	85	1.0	0.437
	72	23	1.1	78.5	87.0	22207TN1	22207KTN1	6600	8000	42	85	1.0	0.428
	80	21	1.5	65.4	75.4	21307CA	21307CAK	5000	6300	44	71	1.5	0.542
	80	21	1.5	74.4	77.7	21307TN1	21307KTN1	5000	6300	44	71	1.5	0.507
40	80	23	1.1	62.6	76.6	22208MB	22208MBK	5500	6600	47	73	1.0	0.55
	80	23	1.1	86.9	93.5	22208CA	22208CAK	6000	7000	47	73	1.0	0.54
	80	23	1.1	86.9	93.5	22208CC	22208CCK	6000	7300	47	73	1.0	0.524
	80	23	1.1	95.3	103.0	22208TN1	22208KTN1	6000	6300	47	73	1.0	0.524
	90	23	1.5	88.8	99.0	21308CA	21308CAK	4600	5500	49	81	1.5	0.75
	90	23	1.5	88.8	99.0	21308CC	21308CCK	4600	5500	49	81	1.5	0.743
	90	23	1.5	93.9	102.0	21308TN1	21308KTN1	4600	5500	49	81	1.5	0.717
	90	33	1.5	89	112	22308MB	22308MBK	5000	6000	49	81	1.5	1.03
	90	33	1.5	123.6	142.1	22308CA	22308CAK	5300	6300	49	81	1.5	1
	90	33	1.5	123.6	142.1	22308CC	22308CCK	5500	7000	49	81	1.5	1.02
	90	33	1.5	133.9	152.4	22308TN1	22308KTN1	5500	7000	48	81	1.5	1.02
45	85	23	1.1	68	83	22209MB	22209MBK	5000	6000	52	78	1.0	0.59
	85	23	1.1	93	102	22209CA	22209CAK	5500	7000	52	78	1.0	0.58

主要尺寸		额定负荷		轴承代号		极限转速		安装尺寸			质量		
Boundary dimensions		Load ratings		Bearing No.		Limiting speeds		Mounting dimensions(mm)			Mass		
(mm)		(kN)		Cylindrical hole		Spherical hole		min	max	max	(kg)		
d	D	B	rsmin	Cr	Cor	圆柱孔	圆锥孔	脂润滑	油润滑				
	85	23	1.1	83	102	22209CC	22209CCK	5500	7000	52	78	1.0	0.571
	85	23	1.1	87	105	22209TN1	21309KTN1	5500	7000	52	78	1.0	0.555
	100	25	1.5	106	118	21309CA	21309CAK	3200	4000	54	91	1.5	1.02
	100	25	1.5	106	118	21309CC	21309CCK	3200	4000	54	91	1.5	1
	100	25	1.5	111	124	21309TN1	21309KTN1	3200	4000	54	91	1.5	0.949
	100	36	1.5	130	152	22309MB	22309MBK	3600	4500	54	91	1.5	1.4
	100	36	1.5	156	175	22309CA	22309CAK	4800	5800	54	91	1.5	1.38
	100	36	1.5	156	175	22309CC	22309CCK	4800	5800	54	91	1.5	1.37
	100	36	1.5	165	191	22309TN1	22309KTN1	4800	5800	54	91	1.5	1.39
50	90	23	1.1	70	89	22210MB	22210MBK	3800	4800	57	83	1.0	0.87
	90	23	1.1	85	112	22210CA	22210CAK	4600	5400	57	83	1.0	0.62
	90	23	1.1	85	112	22210CC	22210CCK	4600	5400	57	83	1.0	0.614
	90	23	1.1	89	113	22210TN1	22210KTN1	4600	5400	57	83	1.0	0.596
	110	27	2.0	124	144	21310CA	21310CAK	2800	3800	60	100	2.0	1.3
	110	27	2.0	129	144	21310CC	21310CCK	2800	3800	60	100	2.0	1.3
	110	27	2.0	129	144	21310TN1	21310KTN1	2800	3800	60	100	2.0	1.22
	110	40	2.0	145	175	22310MB	22310MBK	3400	4300	60	100	2.0	1.9
	110	40	2.0	185	216	22310CA	22310CAK	4600	5600	60	100	2.0	1.85
	110	40	2.0	185	216	22310CC	22310CCK	4600	5600	60	100	2.0	1.79
	110	40	2.0	198	235	22310TN1	22310KTN1	4600	5600	60	100	2.0	1.84
55	100	25	1.5	82	110	22211MB	22211MBK	3400	4300	64	91	1.5	0.86
	100	25	1.5	115	139	22211CA	22211CAK	4000	5000	64	91	1.5	0.84
	100	25	1.5	115	139	22211CC	22211CCK	4000	5200	64	91	1.5	0.847
	100	25	1.5	122	144	22211TN1	22211KTN1	4000	5200	64	91	1.5	0.823
	120	29	2.0	146	175	21311CA	21311CAK	2600	3400	65	110	2.0	1.65
	120	29	2.0	146	175	21311CC	21311CCK	2600	3400	65	110	2.0	1.65
	120	29	2.0	149	170	21311TN1	21311KTN1	2600	3400	65	110	2.0	1.57
	120	43	2.0	170	204	22311MB	22311MBK	3000	3800	65	110	2.0	2.4
	120	43	2.0	224	258	22311CA	22311CAK	4000	4800	65	110	2.0	2.35
	120	43	2.0	226	260	22311CC	22311CCK	4000	4800	65	110	2.0	2.31
	120	43	2.0	232	273	22311TN1	22311KTN1	4000	4800	65	110	2.0	2.32
60	110	28	1.5	101	126	22212MB	22212MBK	3200	4000	69	101	1.5	1.22



主要尺寸			额定负荷			轴承代号		极限转速		安装尺寸			质量	
Boundary dimensions			Load ratings			Bearing No.		Limiting speeds		Mounting dimensions(mm)			Mass	
d	D	B	r _{min}	Cr	Cor	圆柱孔	圆锥孔	圆沟槽	油沟槽	min	max	max	(kg)	
60	110	28	1.5	140	166	22212CA	22212CAK	3600	4500	69	101	1.5	1.2	
	110	28	1.5	140	166	22212CC	22212CCK	3600	4500	69	101	1.5	1.15	
	110	28	1.5	155	191	22212TN1	22212KTN1	3600	4500	69	101	1.5	1.14	
	130	31	2.1	167	201	21312CA	21312CAK	2400	3200	72	118	2.1	2.08	
	130	31	2.1	167	201	21312CC	21312CCK	2400	3200	72	118	2.1	2.08	
	130	31	2.1	175	201	21312TN1	21312KTN1	2400	3200	72	118	2.1	1.98	
	130	46	2.1	193	243	22312MB	22312MBK	2800	3600	72	118	2.1	3	
	130	46	2.1	255	294	22312CA	22312CAK	3800	4400	72	118	2.1	2.95	
	130	46	2.1	255	301	22312CC	22312CCK	3800	4400	72	118	2.1	2.88	
	130	46	2.1	262	312	22312TN1	22312KTN1	3800	4400	72	118	2.1	2.96	
	65	120	31	1.5	112	158	22213MB	22213MBK	2800	3600	74	111	1.5	1.63
		120	31	1.5	165	207	22213CA	22213CAK	3800	4800	74	111	1.5	1.8
120		31	1.5	165	207	22213CC	22213CCK	3800	4800	74	111	1.5	1.54	
120		31	1.5	172	212	22213TN1	22213KTN1	3600	4800	74	111	1.5	1.53	
140		33	2.1	188	235	21313CA	21313CAK	2200	3000	77	128	2.1	2.57	
140		33	2.1	188	235	21313CC	21313CCK	2200	3000	77	128	2.1	2.57	
140		33	2.1	198	235	21313TN1	21313KTN1	2200	3000	77	128	2.1	2.45	
140		48	2.1	222	296	22313MB	22313MBK	2400	3200	77	128	2.1	3.6	
140		48	2.1	282	342	22313CA	22313CAK	3600	4200	77	128	2.1	3.55	
140		48	2.1	262	342	22313CC	22313CCK	3600	4200	77	128	2.1	3.47	
140		48	2.1	295	355	22313TN1	22313KTN1	3600	4200	77	128	2.1	3.57	
70		125	31	1.5	126	175	22214MB	22214MBK	2600	3400	79	116	1.5	1.68
	125	31	1.5	170	221	22214CA	22214CAK	3600	4600	79	116	1.5	1.7	
	125	31	1.5	170	221	22214CC	22214CCK	3600	4600	79	116	1.5	1.6	
	125	31	1.5	180	225	22214TN1	22214KTN1	3600	4600	79	116	1.5	1.6	
	150	35	2.1	218	276	21314CA	21314CAK	2000	2800	82	138	2.1	3.11	
	150	35	2.1	218	276	21314CC	21314CCK	2000	2800	82	138	2.1	3.11	
	150	35	2.1	220	285	21314TN1	21314KTN1	2000	2800	82	138	2.1	2.97	
	150	51	2.1	265	325	22314MB	22314MBK	2200	3000	82	138	2.1	4.4	
	150	51	2.1	321	373	22314CA	22314CAK	3600	4000	82	138	2.1	4.4	
	150	51	2.1	321	400	22314CC	22314CCK	3600	4000	82	138	2.1	4.34	
	150	51	2.1	332	405	22314TN1	22314KTN1	3600	4000	82	138	2.1	4.35	

主要尺寸			额定负荷			轴承代号		极限转速		安装尺寸			质量
Boundary dimensions			Load ratings			Bearing No.		Limiting speeds		Mounting dimensions(mm)			Mass
d	D	B	r _{min}	Cr	Cor	圆柱孔	圆锥孔	圆沟槽	油沟槽	min	max	max	(kg)
75	130	31	1.5	120	148	22215MB	22215MBK	2400	3200	84	121	1.5	1.75
	130	31	1.5	172	222	22215CA	22215ACK	3400	4200	84	121	1.5	1.8
	130	31	1.5	172	222	22215CC	22215CCK	3400	4200	84	121	1.5	1.69
	130	31	1.5	180	232	22215TN1	22215KTN1	3400	4200	84	121	1.5	1.67
	160	37	2.1	245	311	21315CA	21315CAK	1800	2600	87	148	2.1	3.76
	160	37	2.1	245	311	21315CC	21315CCK	1800	2600	87	148	2.1	3.76
	160	37	2.1	245	311	21315TN1	21315KTN1	1800	2600	87	148	2.1	3.63
	160	55	2.1	290	400	22315MB	22315MBK	2000	2800	87	148	2.1	5.4
	160	55	2.1	352	451	22315CA	22315CAK	3000	3800	87	148	2.1	5.25
	160	55	2.1	358	461	22315CC	22315CCK	3000	3800	87	148	2.1	5.28
	160	55	2.1	380	470	22315TN1	22315KTN1	3000	3800	87	148	2.1	5.33
	80	140	33	2.0	140	220	22216MB	22216MBK	2200	3000	90	130	2.0
140		33	2.0	210	265	22216CA	22216CAK	3200	3800	90	130	2.0	2.2
140		33	2.0	210	265	22216CC	22216CCK	3200	3800	90	130	2.0	2.13
140		33	2.0	212	275	22216TN1	22216KTN1	3200	3800	90	130	2.0	2.09
170		39	2.1	268	359	21316CA	21316CAK	1800	2400	92	158	2.1	4.47
170		39	2.1	268	359	21316CC	21316CCK	1800	2400	92	158	2.1	4.47
170		39	2.1	280	350	21316TN1	21316KTN1	1800	2400	92	158	2.1	4.33
170		55	2.1	320	447	22316MB	22316MBK	1900	2600	92	158	2.1	6.4
170		55	2.1	410	513	22316CA	22316CAK	2800	3400	92	158	2.1	6.38
170		55	2.1	410	513	22316CC	22316CCK	2800	3400	92	158	2.1	6.32
170		55	2.1	412	515	22316TN1	22316KTN1	2800	3400	92	158	2.1	6.27
85		150	36	2.0	149	235	22217MB	22217MBK	2000	2800	95	140	2.0
	150	36	2.0	258	330	22217CA	22217CAK	3000	3800	95	140	2.0	2.7
	150	36	2.0	258	330	22217CC	22217CCK	3000	3800	95	140	2.0	2.67
	150	36	2.0	262	340	22217TN1	22217KTN1	3000	3800	95	140	2.0	2.64
	180	41	3.0	307	397	21317CA	21317CAK	1700	2200	99	166	2.5	5.23
	180	41	3.0	307	397	21317CC	21317CCK	1700	2200	99	166	2.5	5.23
	180	41	3.0	310	390	21317TN1	21317KTN1	1700	2200	99	166	2.5	5.07
	180	60	3.0	350	472	22317MB	22317MBK	1800	2400	99	166	2.5	7.4
	180	60	3.0	433	556	22317CA	22317CAK	2500	3200	99	166	2.5	7.25
	180	60	3.0	443	572	22317CC	22317CCK	2500	3200	99	166	2.5	7.27



主要尺寸			额定负荷		轴承代号		极限转速		安装尺寸			质量	
Boundary dimensions			Load ratings		Bearing No.		Limiting speeds		Mounting dimensions(mm)			Mass	
d	D	B	r _{min}	Cr	Cor	圆柱孔	圆锥孔	圆沟滑	油沟滑	min	max	max	(kg)
85	180	60	3.0	480	572	22317TN1	22317KTN1	2600	3200	99	166	2.5	7.27
90	160	40	2.0	202	286	22218MB	22218MBK	1900	2600	100	150	2.0	4
	160	40	2.0	278	358	22218CA	22218CAK	2800	3600	100	150	2.0	3.28
	160	40	2.0	278	358	22218CC	22218CCK	2800	3600	100	150	2.0	3.38
	160	40	2.0	280	378	22218TN1	22218KTN1	2800	3600	100	150	2.0	3.35
	160	52.4	2.0	365	482	23218CA	23218CAK	1700	2200	100	150	2.0	4.6
	160	52.4	2.0	365	497	23218CC	23218CCK	1800	2400	100	150	2.0	4.4
	190	43	3.0	330	433	21318CA	21318CAK	1600	2200	104	176	2.5	6.17
	190	43	3.0	330	433	21318CC	21318CCK	1600	2200	104	176	2.5	6.17
	190	43	3.0	330	420	21318TN1	21318KTN1	1800	2200	104	176	2.5	5.88
	190	64	3.0	376	558	22318MB	22318MBK	1700	2200	104	176	2.5	8.8
95	190	64	3.0	489	641	22318CA	22318CAK	2800	3000	104	176	2.5	8.8
	190	64	3.0	487	659	22318CC	22318CCK	2600	3000	104	176	2.5	8.63
	190	64	3.0	518	660	22318TN1	22318KTN1	2600	3000	104	176	2.5	8.72
	170	43	2.1	218	362	22219MB	22219MBK	1800	2400	107	158	2.1	4.2
	170	43	2.1	310	402	22219CA	22219CAK	2600	3000	107	158	2.1	4.1
	170	43	2.1	312	402	22219CC	22219CCK	2600	3000	107	158	2.1	4.2
	170	43	2.1	310	420	22219CA	22219CAK	2800	3000	107	158	2.1	4.1
	200	45	3.0	366	500	21319CA	21319CAK	1700	2200	109	186	2.5	7.15
	200	45	3.0	366	500	21319CC	21319CCK	1700	2200	109	186	2.5	7.15
	200	45	3.0	365	499	21319TN1	21319KTN1	1700	2200	109	186	2.5	6.9
100	200	87	3.0	397	567	22319MB	22319MBK	1600	2000	109	186	2.5	10.3
	200	87	3.0	536	709	22319CA	22319CAK	2200	2800	109	186	2.5	10.1
	200	87	3.0	546	726	22319CC	22319CCK	2200	2800	109	186	2.5	9.97
	200	87	3.0	568	728	22319TN1	22319KTN1	2200	2800	109	186	2.5	10.1
	165	52	2.0	360	540	23120CA	23120CAK	1600	2000	110	155	2.0	5
	165	52	2.0	382	545	23120CC	23120CCK	1700	2200	110	155	2.0	4.31
	150	50	1.5	251	448	24020CA	24020CAK30	1200	1500	110	140	1.5	3.035
	150	50	1.5	260	461	24020CC	24020CCK30	1200	1500	110	140	1.5	3.035
	180	46	2.1	229	369	22220MB	22220MBK	1700	2200	112	168	2.1	5
	180	46	2.1	352	435	22220CA	22220CAK	2500	3200	112	168	2.1	5
180	46	2.1	352	448	22220CC	22220CCK	2600	3200	112	168	2.1	5.01	

主要尺寸			额定负荷		轴承代号		极限转速		安装尺寸			质量		
Boundary dimensions			Load ratings		Bearing No.		Limiting speeds		Mounting dimensions(mm)			Mass		
d	D	B	r _{min}	Cr	Cor	圆柱孔	圆锥孔	圆沟滑	油沟滑	min	max	max	(kg)	
100	180	46	2.1	368	492	22220TN1	22220KTN1	2600	3200	112	168	2.1	4.97	
	180	60.3	2.1	428	637	23220CA	23220CAK	1600	2000	112	168	2.1	6.7	
	180	60.3	2.1	433	649	23220CC	23220CCK	1600	2200	112	168	2.1	6.52	
	215	47	3.0	397	546	21320CA	21320CAK	1600	2000	114	201	2.5	8.81	
	215	47	3.0	397	546	21320CC	21320CCK	1600	2000	114	201	2.5	8.81	
	215	47	3.0	425	575	21320TN1	21320KTN1	1600	2000	114	201	2.5	8.63	
	215	73	3.0	464	658	22320MB	22320MBK	1800	2200	114	201	2.5	13	
	215	73	3.0	628	840	22320CA	22320CAK	2200	2600	114	201	2.5	13.4	
	215	73	3.0	637	857	22320CC	22320CCK	2200	2800	114	201	2.5	12.8	
	215	73	3.0	658	855	22320TN1	22320KTN1	2200	2600	114	201	2.5	13	
105	175	56	3.0	349	484	23121MB	23121MBK	1400	1800	119	161	2.5	6.64	
	225	49	3.0	420	575	21321CA	21321CAK	1500	1900	119	211	2.5	10	
	225	49	3.0	420	575	21321CC	21321CCK	1500	1900	119	211	2.5	10	
	110	170	45	2.0	201	422	23022MB	23022MBK	1400	1800	120	160	2.0	3.9
		170	45	2.0	278	461	23022CA	23022CAK	1500	1900	120	160	2.0	3.9
		170	45	2.0	280	466	23022CC	23022CCK	1500	1900	120	160	2.0	3.68
		180	56	2.0	270	489	23122MB	23122MBK	1300	1700	120	170	2.0	6.1
		180	56	2.0	386	613	23122CC	23122CAK	1300	1700	120	170	2.0	6.25
		180	56	2.0	389	620	23122CC	23122CCK	1600	2000	120	170	2.0	5.51
		180	69	2.0	472	798	24122CA	24122CAK30	1600	2000	120	170	2.0	6.63
180		69	2.0	472	798	24122CC	24122CCK30	1600	2000	120	170	2.0	6.63	
200		53	2.1	297	497	22222MB	22222MBK	1800	2200	122	188	2.1	7.4	
200		53	2.1	447	592	22222CA	22222CAK	2200	3000	122	188	2.1	7.2	
120	200	53	2.1	452	606	22222CC	22222CCK	2400	3000	122	188	2.1	7.32	
	200	69.8	2.1	530	809	23222CA	23222CAK	1400	1800	122	188	2.1	9.7	
	200	69.8	2.1	538	824	23222CC	23222CCK	1500	1900	122	188	2.1	9.46	
	240	50	3.0	460	635	21322CA	21322CAK	1400	1800	124	226	2.5	11.8	
	240	50	3.0	474	654	21322CC	21322CCK	1400	1800	124	226	2.5	11.8	
	240	80	3.0	561	857	22322MB	22322MBK	1200	1600	124	226	2.5	18.1	
	240	80	3.0	786	993	22322CC	22322CAK	1800	2200	124	226	2.5	18	
	240	80	3.0	786	997	22322CC	22322CCK	1900	2300	124	226	2.5	17.5	
	120	180	46	2.0	218	484	23024MB	23024MBK	1200	1600	130	170	2.5	4.3



主要尺寸			额定负荷		轴承代号		极限转速		安装尺寸			质量	
Boundary dimensions			Load ratings		Bearing No.		Limiting speeds		Mounting dimensions(mm)			Mass	
d	D	B	r _{min}	Cr	Cor	圆柱孔	圆锥孔	圆沟槽	油沟槽	min	max	max	(kg)
120	180	46	2.0	354	560	23024CA	23024CAK	1400	1800	130	170	2.0	4.3
	180	46	2.0	359	565	23024CC	23024CCK	1800	2200	130	170	2.0	3.98
	180	60	2.0	390	700	24024CC	24024CAK30	1500	2000	130	170	2.0	5.05
	180	60	2.0	391	700	24024CC	24024CCK	1500	2000	130	170	2.0	5.05
	200	62	2.0	321	589	23124MB	23124MBK	1100	1500	130	190	2.0	7.63
	200	62	2.0	531	780	23124CA	23124CAK	1300	1700	130	190	2.0	7.63
	200	62	2.0	530	780	23124CC	23124CCK	1400	1800	130	190	2.0	7.67
	200	80	2.0	645	1028	24124CA	24124CAK30	1400	1800	130	190	2.0	9.65
	200	80	2.0	645	1028	24124CC	24124CCK30	1400	1800	130	190	2.0	9.65
	215	58	2.1	352	582	22224MB	22224MBK	1300	1700	132	203	2.1	9.2
	215	58	2.1	520	730	22224CA	22224CAK	2500	2800	132	203	2.1	9
	215	58	2.1	520	730	22224CC	22224CCK	2500	2800	132	203	2.1	9.1
	215	76	2.1	660	968	23224CA	23224CAK	1300	1700	132	203	2.1	12
	215	76	2.1	668	984	23224CC	23224CCK	1300	1700	132	203	2.1	11.7
	260	86	3.0	664	1022	22324MB	22324MBK	1100	1500	134	246	2.5	22
	260	86	3.0	857	1154	22324CA	22324CAK	1700	2000	134	246	2.5	22
	260	86	3.0	870	1195	22324CC	22324CCK	1900	2200	134	246	2.5	22.2
130	200	52	2.0	278	626	23026MB	23026MBK	1100	1500	140	190	2.0	6.2
	200	52	2.0	383	644	23026CA	23026CAK	1200	1600	140	190	2.0	6.2
	200	52	2.0	386	649	23026CC	23026CCK	1700	2000	140	190	2.0	5.85
	200	69	2.0	472	852	24026CA	24026CAK30	1400	1800	140	190	2.0	7.55
	200	69	2.0	486	878	24026CC	24026CCK30	1400	1800	140	190	2.0	7.55
	210	64	2.0	482	812	23126CA	23126CAK	1300	1700	140	200	2.0	8.49
	210	64	2.0	496	826	23126CC	23126CCK	1300	1700	140	200	2.0	8.49
	210	80	2.0	585	1030	24126CA	24126CAK30	1200	1600	140	200	2.0	10.3
	210	80	2.0	603	1061	24126CC	24126CCK30	1300	1700	140	200	2.0	10.3
	230	64	3.0	420	729	22226MB	22226MBK	1200	1600	144	216	2.5	11.2
	230	64	3.0	625	864	22226CA	22226CAK	2000	2600	144	216	2.5	11.2
	230	64	3.0	625	867	22226CC	22226CCK	2200	2600	144	216	2.5	11.2
	230	80	3.0	748	1092	23226CA	23226CAK	1200	1600	144	216	2.5	14
	230	80	3.0	748	1112	23226CC	23226CCK	1200	1600	144	216	2.5	13.8
	230	93	4.0	744	1170	22326MB	22326MBK	950	1300	148	262	3.0	29

主要尺寸			额定负荷		轴承代号		极限转速		安装尺寸			质量	
Boundary dimensions			Load ratings		Bearing No.		Limiting speeds		Mounting dimensions(mm)			Mass	
d	D	B	r _{min}	Cr	Cor	圆柱孔	圆锥孔	圆沟槽	油沟槽	min	max	max	(kg)
130	280	93	4.0	970	1340	22326CA	22326CAK	1600	1900	148	262	3.0	28.5
	280	93	4.0	994	1380	22326CC	22326CCK	1600	1900	148	262	3.0	27.5
140	210	53	2.0	294	654	23028MB	23028MBK	950	1300	150	200	2.0	6.7
	210	53	2.0	444	719	23028CA	23028CAK	1100	1500	150	200	2.0	6.7
	210	53	2.0	450	760	23028CC	23028CCK	1600	1900	150	200	2.0	6.31
	210	69	2.0	488	895	24028CA	24028CAK30	1200	1600	150	200	2.0	8.01
	210	69	2.0	503	922	24028CC	24028CCK30	1300	1700	150	200	2.0	8.01
	225	68	2.1	410	623	21328MB	21328MBK	950	1300	152	213	2.1	10.9
	225	68	2.1	561	853	23128CA	23128CAK	1100	1500	152	213	2.1	10.9
	225	68	2.1	554	832	23128CC	23128CCK	1200	1600	152	213	2.1	10.2
	225	85	2.1	670	1200	24128CA	24128CAK30	1100	1500	152	213	2.1	12.5
	225	85	2.1	690	1236	24128CC	24128CCK30	1200	1600	152	213	2.1	12.5
	225	68	3.0	492	829	22228MB	22228MBK	1000	1400	154	236	2.5	14.5
	250	68	3.0	720	990	22228CA	22228CAK	1700	2200	154	236	2.5	14.5
	250	68	3.0	720	990	22228CC	22228CCK	1800	2200	154	236	2.5	14.2
	250	88	3.0	826	1320	23228CA	23228CAK	1000	1400	154	236	2.5	18.5
	250	88	3.0	836	1340	23228CC	23228CCK	1100	1500	154	236	2.5	18.1
	300	102	4.0	850	1380	22328MB	22328MBK	900	1200	158	282	3.0	36
	300	102	4.0	1140	1620	22328CA	22328CAK	1400	1500	158	282	3.0	34.5
	300	102	4.0	1164	1660	22328CC	22328CCK	1400	1700	158	282	3.0	34.6
150	225	56	2.1	338	790	23030MB	23030MBK	900	1200	162	213	2.1	8.14
	225	56	2.1	451	790	23030CA	23030CAK	1100	1400	162	213	2.1	8.14
	225	56	2.1	445	772	23030CC	23030CCK	1400	1800	162	213	2.1	7.74
	225	75	2.1	570	1070	24030CA	24030CAK30	1100	1400	162	213	2.1	10.6
	225	75	2.1	587	1100	24030CC	24030CCK30	1200	1500	162	213	2.1	10.1
	250	80	2.1	527	1110	23130MB	23130MBK	850	1100	162	238	2.1	16.1
	250	80	2.1	747	1267	23130CA	23130CAK	1000	1300	162	238	2.1	16.1
	250	80	2.1	760	1288	23130CC	23130CCK	1100	1400	162	238	2.1	15.7
	250	100	2.1	890	1600	24130CA	24130CAK30	1000	1300	162	238	2.1	19
	250	100	2.1	910	1650	24130CC	24130CCK30	1100	1400	162	238	2.1	19
	270	73	3.0	523	900	22230MB	22230MBK	1200	1700	164	256	2.5	18.5
	270	73	3.0	523	1330	22230CA	22230CAK	1800	2000	164	256	2.5	18.6



主要尺寸			额定负荷			轴承代号		极限转速		安装尺寸			质量
Boundary dimensions			Load ratings			Bearing No.		Limiting speeds		Mounting dimensions(mm)			Mass
d	D	B	r _{min}	Cr	Cor	圆柱孔	圆锥孔	圆润滑	油润滑	min	max	max	(kg)
150	270	73	3.0	970	1130	22230CC	22230CCK	1800	2000	164	256	2.5	18
	270	96	3.0	963	1560	23230CA	23230CAK	950	1300	164	256	2.5	24
	270	96	3.0	976	1586	23230CC	23230CCK	1100	1400	164	256	2.5	23.2
	320	108	4.0	1050	1790	22330MB	22330MBK	850	1100	168	302	3.0	43
	320	108	4.0	1270	1850	22330CA	22330CAK	1200	1500	168	302	3.0	42.5
	320	108	4.0	1308	1905	22330CC	22330CCK	1200	1500	168	302	3.0	42
160	240	60	2.1	379	850	23032MB	23032MBK	850	1100	172	228	2.1	10
	240	80	2.1	515	900	23032CA	23032CAK	1000	1300	172	228	2.1	10
	240	80	2.1	523	915	23032CC	23032CCK	1300	1700	172	228	2.1	9.43
	240	80	2.1	852	1230	24032CC	24032CAK30	1000	1300	172	228	2.1	12.2
	240	80	2.1	870	1260	24032CC	24032CCK30	1100	1400	172	228	2.1	12.2
	270	86	2.1	536	1140	23132MB	23132MBK	800	1000	172	268	2.1	19.7
	270	86	2.1	870	1460	23132CA	23132CAK	900	1200	172	268	2.1	19.7
	270	86	2.1	870	1480	23132CC	23132CCK	1000	1300	172	268	2.1	19.8
	270	109	2.1	1040	1880	24132CA	24132CAK30	900	1200	172	268	2.1	24.6
	270	109	2.1	1070	1930	24132CC	24132CCK30	1000	1300	172	268	2.1	24.4
	290	80	3.0	660	1170	22232MB	22232MBK	1500	1700	174	276	2.5	22.2
	290	80	3.0	895	1280	22232CA	22232CAK	1700	1900	174	276	2.5	23.1
	290	80	3.0	901	1320	22232CC	22232CCK	1200	1900	174	276	2.5	22.9
	290	104	3.0	1112	1810	23232CA	23232CAK	900	1200	174	276	2.5	30
	290	104	3.0	1120	1830	23232CC	23232CCK	1100	1400	174	276	2.5	29.4
	340	114	4.0	1370	1820	22332MB	22332MBK	1100	1300	178	322	3.0	51
170	260	87	2.1	458	1040	23034MB	23034MBK	800	1000	182	248	2.1	13
	260	87	2.1	726	1172	23034CA	23034CAK	900	1200	182	248	2.1	13
	260	87	2.1	733	1173	23034CC	23034CCK	1200	1600	182	248	2.1	12.8
	260	90	2.1	792	1520	24034CA	24034CAK30	900	1200	182	248	2.1	16.7
	260	90	2.1	816	1565	24034CC	24034CCK30	1000	1300	182	248	2.1	16.7
	280	88	2.1	911	1565	23134CA	23134CAK	850	1100	182	268	2.1	21.1
	280	88	2.1	927	1590	23134CC	23134CCK	1000	1300	182	268	2.1	21.1
	280	109	2.1	1070	1930	24134CA	24134CAK30	900	1200	182	268	2.1	25.6
	280	109	2.1	1100	1980	24134CC	24134CCK30	1000	1300	182	268	2.1	25.6
	310	86	4.0	740	1330	22234MB	22234MBK	1100	1300	188	292	3.0	29

主要尺寸			额定负荷			轴承代号		极限转速		安装尺寸			质量
Boundary dimensions			Load ratings			Bearing No.		Limiting speeds		Mounting dimensions(mm)			Mass
d	D	B	r _{min}	Cr	Cor	圆柱孔	圆锥孔	圆润滑	油润滑	min	max	max	(kg)
170	310	86	4.0	975	1500	22234CA	22234CAK	1300	1600	188	292	3.0	29
	310	86	4.0	1002	1540	22234CC	22234CCK	1100	1400	188	292	3.0	28.1
	310	110	4.0	1200	2030	23234CA	23234CAK	800	1100	188	292	3.0	35.7
	310	110	4.0	1230	2090	23234CC	23234CCK	900	1200	188	292	3.0	35.7
	360	120	4.0	1380	2120	22334CA	22334CAK	1100	1200	188	342	3.0	60
180	280	74	2.1	556	1260	23036MB	23036MBK	750	950	192	268	2.1	17.6
	280	74	2.1	830	1350	23036CA	23036CAK	900	1100	192	268	2.1	17.6
	280	74	2.1	840	1350	23036CC	23036CCK	1200	1400	192	268	2.1	16.9
	280	100	2.1	828	1620	24036CA	24036CAK30	900	1100	192	268	2.1	22.1
	280	100	2.1	855	1670	24036CC	24036CCK30	1100	1300	192	268	2.1	22.1
	300	96	3.0	950	1620	23136MB	23136MBK	750	900	194	286	2.5	27.1
	300	96	3.0	1060	1850	23136CA	23136CAK	800	1000	194	286	2.5	27.1
	300	96	3.0	1080	1880	23136CC	23136CCK	900	1200	194	286	2.5	26.9
	300	118	3.0	1210	2220	24136CA	24136CAK30	800	1000	194	286	2.5	32
	300	118	3.0	1240	2280	24136CC	24136CCK30	900	1200	194	286	2.5	32
	320	86	4.0	757	1410	22236MB	22236MBK	800	1100	198	302	3.0	30
	320	86	4.0	1010	1590	22236CA	22236CAK	1300	1700	120	170	2.0	6.1
	320	86	4.0	1040	1630	22236CC	22236CCK	1100	1300	198	302	3.0	29.4
	320	112	4.0	1280	2170	23236CA	23236CAK	1000	1200	198	302	3.0	37.9
	320	112	4.0	1310	2230	23236CC	23236CCK	1100	1300	198	302	3.0	37.9
	380	126	4.0	1490	2330	22336CA	22336CAK	1000	1100	198	362	3.0	70
190	290	75	2.1	570	1280	23038MB	23038MBK	700	900	202	278	2.1	20
	290	75	2.1	867	1490	23038CA	23038CAK	1000	1200	202	278	2.1	20
	290	75	2.1	877	1520	23038CC	23038CCK	1100	1400	202	278	2.1	17.7
	290	100	2.1	975	1910	24038CA	24038CAK30	800	1100	202	278	2.1	23
	290	100	2.1	1004	1960	24038CC	24038CCK30	900	1200	202	278	2.1	23
	320	104	3.0	811	1880	23138MB	23138MBK	670	850	204	306	2.5	35.3
	320	104	3.0	1200	2120	23138CA	23138CAK	750	1000	204	306	2.5	35.3
	320	104	3.0	1230	2180	23138CC	23138CCK	850	1100	204	306	2.5	17.7
	320	128	3.0	1410	2590	24138CA	24138CAK30	700	1000	204	306	2.5	40.2
	320	128	3.0	1450	2660	24138CC	24138CCK30	850	1100	204	306	2.5	40.2
	340	82	4.0	1100	1655	22238CA	22238CAK	1200	1500	208	322	3.0	35.3

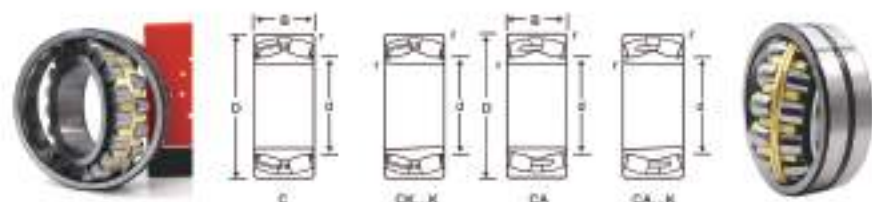
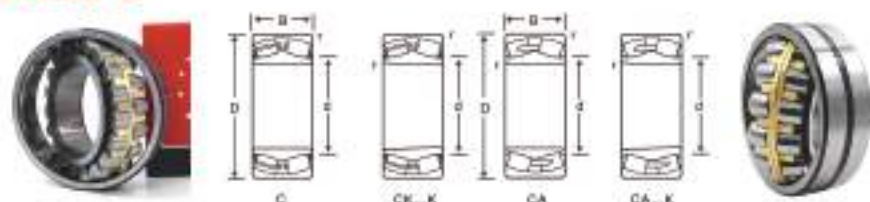

主要尺寸		额定负荷		轴承代号		极限转速		安装尺寸			质量		
Boundary dimensions		Load ratings		Bearing No.		Limiting speeds		Mounting dimensions(mm)			Mass		
d	D	B	r/min	Cr	Cor	圆柱孔	圆锥孔	内润滑	外润滑	min	max	max	
190	340	120	4.0	1450	2490	23238CA	23238CAK	700	1000	208	322	3.0	46.1
	340	120	4.0	1490	2550	23238CC	23238CCK	800	1100	208	322	3.0	46.1
	400	132	5.0	1730	2600	22338CA	22338CAK	900	1000	212	378	4.0	81
200	310	82	2.1	897	1340	23040MB	23040MBK	670	850	212	298	2.1	24
	310	82	2.1	890	1650	23040CA	23040CAK	900	1100	212	298	2.1	24
	310	82	2.1	916	1690	23040CC	23040CCK	1000	1300	212	298	2.1	22.7
	310	109	2.1	1120	2220	24040CA	24040CAK30	670	850	212	298	2.1	29.3
	310	109	2.1	1150	2280	24040CC	24040CCK30	850	1100	212	298	2.1	29.3
	340	112	3.0	937	2070	23140MB	23140MBK	630	800	214	326	2.5	50.7
	340	112	3.0	1420	2530	23140CC	23140CCK	800	1000	214	326	2.5	47.6
	340	140	3.0	1480	2550	24140MB	24140KMB30	700	900	214	326	2.5	49.55
	340	140	3.0	1620	3030	24140CC	24140CCK30	800	1000	214	326	2.5	49.9
	360	98	4.0	1100	1890	22240CA	22240CAK	1100	1400	218	342	3.0	47.7
	360	128	4.0	1650	2870	23240CC	23240CCK	750	1000	218	342	3.0	55.4
	420	138	5.0	1730	2800	22340CA	22340CAK	730	900	222	398	4.0	94
220	340	90	3.0	793	1860	23044MB	23044MBK	600	750	234	326	2.5	28.8
	340	90	3.0	1090	2040	23044CC	23044CCK	950	1200	234	326	2.5	29.7
	340	118	3.0	1370	2760	24044CC	24044CCK30	750	1000	234	326	2.5	38.1
	370	120	4.0	1060	2420	23144MB	23144MBK	600	750	238	352	3.0	55
	370	120	4.0	1610	2900	23144CC	23144CCK	700	950	238	352	3.0	51.5
	370	150	4.0	1900	3580	24144CC	24144CCK30	700	950	238	352	3.0	62.3
	400	108	4.0	1500	2380	22244CA	22244CAK	730	900	238	382	3.0	61.5
	400	144	4.0	2130	3720	23244CC	23244CCK	670	900	238	382	3.0	78.5
	460	145	5.0	2140	3290	22344CA	22344CAK	660	800	242	438	4.0	120
240	360	92	3.0	816	2120	23048MB	23048MBK	530	670	254	346	2.5	35.5
	360	92	3.0	1160	2220	23048CC	23048CCK	850	1100	254	346	2.5	32.4
	360	118	3.0	1440	2930	24048CC	24048CCK30	700	950	254	346	2.5	40.8
	400	128	4.0	1230	2910	23148MB	23148MBK	500	630	258	382	3.0	55.5
	400	128	4.0	1840	3310	23148CC	23148CCK	670	850	258	382	3.0	63.7
	400	160	4.0	2160	4090	24148CC	24148CCK30	670	850	258	382	3.0	76.9
	440	160	4.0	2560	4620	23248CC	23248CCK	630	800	258	422	3.0	107.3
	500	155	5.0	2580	3840	22348CA	22348CAK	600	750	262	478	4.0	153

主要尺寸		额定负荷		轴承代号		极限转速		安装尺寸			质量		
Boundary dimensions		Load ratings		Bearing No.		Limiting speeds		Mounting dimensions(mm)			Mass		
d	D	B	r/min	Cr	Cor	圆柱孔	圆锥孔	内润滑	外润滑	min	max	max	
260	400	104	4.0	1030	2520	23052CA	23052CAK	500	630	278	382	3.0	51.6
	400	104	4.0	1460	2850	23052CC	23052CCK	900	1100	278	382	3.0	47.7
	400	140	4.0	1840	3850	24052CC	24052CCK30	630	850	278	382	3.0	62.4
	440	144	4.0	1470	3410	23152MB	23152MBK	450	560	278	422	3.0	95.3
	440	144	4.0	2270	4190	23152CC	23152CCK	600	800	278	422	3.0	88.2
	440	180	4.0	2730	5330	24152CC	24152CCK30	600	800	278	422	3.0	107.6
	540	165	6.0	2860	4310	22352CA	22352CAK	480	700	286	512	5.0	191
280	420	106	4.0	1110	2760	23058CA	23058CAK	450	560	298	402	3.0	62
	420	106	4.0	1580	3030	23058CC	23058CCK	700	900	298	402	3.0	50.9
	420	140	4.0	1960	4100	24058CC	24058CCK	800	900	298	402	3.0	65.8
	420	146	5.0	1635	3730	23158CA	23158CAK	430	530	302	438	4.0	103
	460	146	5.0	2380	4410	23158CC	23158CCK	560	750	302	438	4.0	94.1
	460	180	5.0	2810	5480	24158CC	24158CCK30	560	750	302	438	4.0	113.2
	500	130	5.0	2150	3480	22258MB	22258MBK	800	900	302	478	4.0	112.3
	580	175	6.0	3490	5200	22358CA	22358CAK	450	600	308	552	5.0	238
300	460	118	4.0	1290	3160	23060MB	23060MBK	430	530	318	442	3.0	75.2
	460	118	4.0	1910	3800	23060CC	23060CCK	670	850	318	442	3.0	71.4
	460	160	4.0	2430	5160	24060CC	24060CCK30	530	700	318	442	3.0	94.1
	500	180	5.0	2250	4550	23160MB	23160MBK	500	700	322	478	4.0	133
	540	140	5.0	2520	3950	22260CA	22260CAK	700	850	322	518	4.0	134
320	480	121	4.0	1930	4000	23064CA	23064CAK	600	800	338	462	3.0	84.7
	480	160	4.0	2480	5100	24064CA	24064CAK30	560	700	338	462	3.0	106
	540	176	5.0	3150	5200	23164CA	23164CAK	630	700	342	518	4.0	200
	580	150	5.0	2490	4550	22264CA	22264CAK	670	850	342	558	4.0	175
	580	208	5.0	3920	8820	23264CA	23264CAK	500	630	342	558	4.0	253
340	520	133	5.0	1980	4400	23068CA	23068CAK	700	900	362	498	4.0	115
	520	180	5.0	2460	5700	24068CA	24068CAK30	530	670	362	498	4.0	137
	580	190	5.0	3050	6300	23168CA	23168CAK	600	750	362	558	4.0	206
360	540	134	5.0	2280	4800	23072CA	23072CAK	670	850	382	518	4.0	126
	600	192	5.0	3250	6850	23172CA	23172CAK	590	700	382	578	4.0	255
	600	243	5.0	5600	8400	24172CA	24172CAK30	300	360	382	578	4.0	270
	650	232	6.0	4650	8300	23272CA	23272CAK	400	500	382	622	5.0	330



主要尺寸			额定载荷		轴承代号		极限转速		安装尺寸			质量	
Boundary dimensions			Load ratings		Bearing No.		Limiting speeds		Mounting dimensions(mm)			Mass	
(mm)			(kN)		Cylindrical hole		Spherical hole		min	max	max	(kg)	
d	D	B	r _{min}	C _r	C _{or}	圆柱孔	圆球孔	油润滑	油润滑	min	max	max	
360	750	224	7.5	4900	8600	22372CA	22372CAK	400	500	392	720	6.0	466
380	560	135	5.0	2480	5000	23076CA	23076CAK	630	800	402	538	4.0	130
	560	180	5.0	3150	6800	24076CA	24076CAK30	480	600	402	538	4.0	153
	620	194	5.0	3400	7350	23176CA	23176CAK	400	500	402	598	4.0	244
400	600	148	5.0	2540	5900	23080CA	23080CAK	600	750	422	578	4.0	158
	600	200	5.0	3600	7800	24080CA	24080CAK30	450	560	422	578	4.0	202
	650	200	6.0	4080	7650	23180CA	23180CAK	380	480	428	622	5.0	275
	720	256	6.0	6140	11300	23280CA	23280CAK	340	430	428	692	5.0	353
	820	243	7.5	6840	11200	22380CA	22380CAK	380	450	428	792	6.0	650

带密封圈调心滚子轴承是一种两侧带骨架密封圈的闭式结构轴承。该轴承具有调心滚子轴承的功能之外，还具有内部运转环境优良的特点，有利于轴承的长寿命。广泛用于工程机械和电梯上。

With a self-aligning roller Spherical roller bearing is a two-sided belt skeleton Seal of the closed structure of the bearing. The bearing has a self-aligning roller Bearing the function, but also has an excellent internal operating environment Features that favor the bearing's long life. Widely used in engineering machine And on the elevator.



轴承代号 Bearing No.	主要尺寸 Boundary dimensions(mm)				极限转速 Limiting speeds (r/min)	额定负荷 Load ratings(KN)		质量 Mass (kg)
	d	D	B	mm		Cr	Cor	
BS2-2205-2CS	25	52	23	1	3600	49	44	0.26
BS2-2206-2CS	30	62	25	1	2800	64	60	0.34
BS2-2207-2CS	35	72	28	1.1	2400	86.5	85	0.52
BS2-2208-2CS	40	80	1.1	1.1	2200	96.5	90	0.57
BS2-2209-2CS	45	85	26	1.1	2000	102	98	0.66
BS2-2210-2CS	50	90	28	1.1	1900	104	108	0.70
BS2-2211-2CS	55	100	31	1.5	1700	125	127	1.00
BS2-2212-2CS	60	110	34	1.5	1600	156	166	1.13
BS2-2213-2CS	65	120	38	1.5	1500	193	216	1.6
BS2-2214-2CS	70	125	38	1.5	1400	208	228	1.8
BS2-2215-2CS	75	130	38	1.5	1300	212	240	2.10
BS2-2216-2CS	80	140	40	2	1200	236	270	2.40
BS2-2217-2CS	85	150	44	2	1100	285	325	3.00
BS2-2218-2CS	90	160	48	2	1000	326	375	3.7
BS2-2220-2CS	100	180	50	2.1	900	425	490	5.50
BS2-2222-2CS	110	200	63	2.1	800	560	560	7.60
BS2-2224-2CS	120	215	69	2.1	750	630	765	9.75
BS2-2308-2CS	40	90	38	1.5	1900	150	140	1.20
BS2-2309-2CS	45	100	42	1.5	1500	183	183	1.6
BS2-2310-2CS	50	110	46	2	1400	220	224	2.1
BS2-2311-2CS	55	120	49	2	1400	270	280	2.8
BS2-2312-2CS	60	130	53	2.1	1100	310	335	3.4
BS2-2313-2CS	65	140	53	2.1	1000	340	360	4.15
BS2-2314-2CS	70	150	60	2.1	900	400	430	5.1
BS2-2315-2CS	75	160	64	2.1	950	440	475	6.5
BS2-2316-2CS	70	170	67	2.1	800	490	540	7.2
2324-2CS	120	260	86	3	600	960	1120	23
23022-2CS	110	170	45	2	900	310	440	3.8
23024-2CS	120	180	46	2	850	355	510	4.2
23120-2CS	100	165	52	2	850	365	490	4.4
23122-2CS	110	180	56	2	800	430	430	5.75
23218-2CS	90	160	52.4	2	750	355	440	4.65
23220-2CS	100	180	60.3	2.1	700	475	600	6.85

轴承代号 Bearing No.	主要尺寸 Boundary dimensions(mm)				极限转速 Limiting speeds (r/min)	额定负荷 Load ratings(KN)		质量 Mass (kg)
	d	D	B	mm		Cr	Cor	
23222-2CS	110	200	69.8	2.1	640	600	765	9.85
23224-2CS	120	215	76	2.1	600	695	930	12
24015-2CS	75	115	40	1.1	950	173	232	1.55
24020-2CS	100	150	50	1.5	800	285	415	3.20
24022-2CS	110	170	45	2	670	415	620	5
24024-2CS	120	180	60	2	670	430	670	5.45
24120-2CS	100	165	65	2	670	455	640	5.65
24122-2CS	110	180	69	2	630	520	750	7.10
24124-2CS	120	200	80	2	560	655	950	10.5



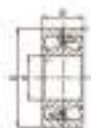
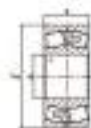

振动机械专用轴承主要用于矿山机械装置和一些振动压力设备。例如：振动筛、压路机和锯齿形的切割机械等。

Vibration machinery bearings are mainly used for mining machinery and some vibration pressure equipment. Such as vibrating screens, rollers and sawtooth cutting machines.



主要尺寸		额定负荷		轴承代号	极限转速		安装尺寸			质量		
Boundary dimensions		Load ratings			Limiting speeds		Mounting dimensions (mm)					
(mm)		(kN)		Bearing No.	(r/min)		da	Di	rs	Mass (kg)		
d	D	B	rsmin		Cr	Cor	滚动滑	油润滑	min		max	max
40	90	33	1.5	127	146	22309MA/W33	4300	5300	52	78	1.5	1.044
45	100	36	1.5	153	179	22310MA/W33	3900	4800	56	91	1.5	1.044
50	110	40	2.0	195	226	22311MA/W33	3600	4500	60	100	2.1	1.827
55	120	43	2.0	226	268	22312MA/W33	3200	4000	65	110	2.1	2.461
60	130	46	2.1	262	313	22313MA/W33	3000	3800	72	118	2.1	3.088
65	140	48	2.1	285	340	22314MA/W33	2600	3400	77	128	2.1	3.705
70	150	51	2.1	330	420	22315MA/W33	2600	3200	82	138	2.1	4.501
75	160	55	2.1	380	475	22316MA/W33	2300	3000	87	148	2.1	5.552
80	170	58	2.1	420	535	22317MA/W33	2100	2800	92	158	2.1	6.537
85	180	60	3.0	482	591	22318MA/W33	2000	2600	99	166	2.5	7.542
90	190	64	3.0	518	677	22319MA/W33	1900	2400	104	176	2.5	9.056
95	200	67	3.0	568	744	22320MA/W33	1900	2300	109	186	2.5	10.43
100	215	73	3.0	659	875	22321MA/W33	1700	2100	114	201	2.5	13.34
110	240	80	3.0	795	1020	22322MA/W33	1500	1900	124	226	2.5	18.62
120	260	86	3.0	921	1195	22324MA/W33	1300	1800	134	246	2.5	23.17
130	280	93	4.0	1160	1560	22326MA/W33	1300	1700	148	262	3.0	28.78
140	300	102	4.0	1230	1700	22328MA/W33	1200	1600	158	282	3.0	36.18
150	320	108	4.0	1390	1800	22330MA/W33	1200	1500	168	302	3.0	43.35
160	340	114	4.0	1330	1810	22332MA/W33	800	1000	178	322	3.0	51.76
170	360	120	4.0	1470	1960	22334MA/W33	750	950	188	342	3.0	61.39
180	380	126	4.0	1620	2170	22336MA/W33	700	900	198	362	3.0	71.25
190	400	132	5.0	2000	2400	22338MA/W33	650	850	208	382	4.0	81.02